

# CHTR6145C

New Products

RoHS

AEC-Q200

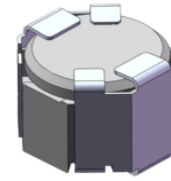

■ Features

- Ideal for harsh ECU environments
- High heat resistance (180°C)
- High vibration resistance (20G)
- Supports back mounting

■ Magnetic structure



Operating Temperature Range : -40 °C~ +180 °C(include self-heating)

Weight : 0.5 g

■ Application

- Power supply for microcomputers in home appliances
- Power supply circuit for HEV / EV

■ Dimensions

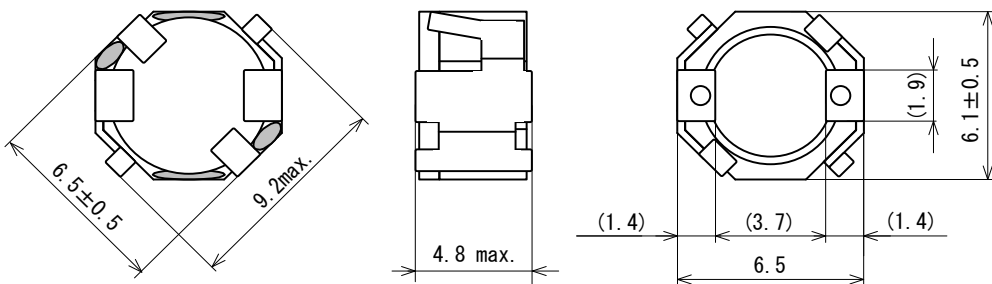

(Unit : mm)

■ Recommended Land Pattern

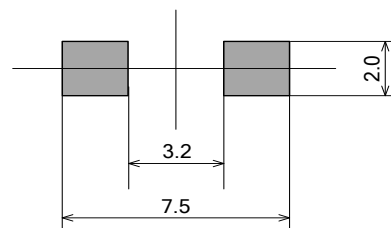

(Unit : mm)



SAGAMI ELEC CO., LTD.  
<https://www.sagami-elec.co.jp>

10-30, Ichibashimo-cho, Tsurumi-ku, Yokohama, Kanagawa 230-0024, Japan  
 Over Seas Sales Dept. TEL : +81 45 511 3141, E-mail : ossg@sagami-elec.co.jp  
 Engineering Dept. TEL : +81 45 521 4543

⚠ The contents of this catalogue are subject to change without notice.

## ■ Specifications

SAGAMI Part No.	Inductance ( $\mu\text{H}$ )	DCR Resistance ( $\Omega$ ) $\pm 30\%$	Rated current			
			DC saturation allowable current (A)		Temperature rise allowable current (A)	
			Spec.	Typical	Spec.	Typical
CHTR6145C-R82N	0.82 $\pm 30\%$	0.0150	5.50	8.80	4.20	6.00
CHTR6145C-1R2N	1.2 $\pm 30\%$	0.0170	4.30	6.60	3.70	5.20
CHTR6145C-1R8N	1.8 $\pm 30\%$	0.0190	3.60	6.00	3.40	4.80
CHTR6145C-3R3N	3.3 $\pm 30\%$	0.0240	2.70	4.80	2.90	4.20
CHTR6145C-4R7N	4.7 $\pm 30\%$	0.0310	2.40	4.00	2.60	3.70
CHTR6145C-6R8N	6.8 $\pm 30\%$	0.0480	1.90	3.40	2.00	2.90
CHTR6145C-100M	10 $\pm 20\%$	0.0670	1.60	2.50	1.60	2.30
CHTR6145C-150M	15 $\pm 20\%$	0.120	1.30	2.00	1.20	1.70
CHTR6145C-220M	22 $\pm 20\%$	0.210	1.10	1.80	0.900	1.30
CHTR6145C-330M	33 $\pm 20\%$	0.250	0.870	1.50	0.800	1.10
CHTR6145C-470N	47 $\pm 20\%$	0.310	0.730	1.20	0.750	1.00
CHTR6145C-680M	68 $\pm 20\%$	0.410	0.600	1.00	0.620	0.880
CHTR6145C-101M	100 $\pm 20\%$	0.670	0.480	0.790	0.510	0.720
CHTR6145C-151M	150 $\pm 20\%$	0.860	0.380	0.670	0.410	0.580
CHTR6145C-221M	220 $\pm 20\%$	1.81	0.320	0.550	0.310	0.440
CHTR6145C-331M	330 $\pm 20\%$	2.21	0.260	0.410	0.270	0.390
CHTR6145C-471M	470 $\pm 20\%$	2.71	0.210	0.380	0.250	0.350
-	-	-	-	-	-	-
-	-	-	-	-	-	-
-	-	-	-	-	-	-
-	-	-	-	-	-	-
-	-	-	-	-	-	-
-	-	-	-	-	-	-
-	-	-	-	-	-	-
-	-	-	-	-	-	-
-	-	-	-	-	-	-
-	-	-	-	-	-	-
-	-	-	-	-	-	-
-	-	-	-	-	-	-
-	-	-	-	-	-	-
-	-	-	-	-	-	-
-	-	-	-	-	-	-

- Inductance Measuring Condition : 100kHz,1V
- Rated current : DC saturation allowable current or Temperature rise allowable current, whichever is smaller.
  1. DC saturation allowable current (Spec.) : value of inductance decrease within 30%.  
DC saturation allowable current (Typical) : value of inductance decrease 30%.
  2. Temperature rise allowable current (Spec.) : A rise in temperature of core surface is within 40°C.  
Temperature rise allowable current (Typical) : A rise in temperature of core surface is 40°C.



SAGAMI ELEC CO., LTD.  
<https://www.sagami-elec.co.jp>

10-30, Ichibashimo-cho, Tsurumi-ku, Yokohama, Kanagawa 230-0024, Japan  
 Over Seas Sales Dept. TEL: +81 45 511 3141, E-mail: ossg@sagami-elec.co.jp  
 Engineering Dept. TEL: +81 45 521 4543

⚠ The contents of this catalogue are subject to change without notice.

## ■ Characteristics of DC Saturation Current

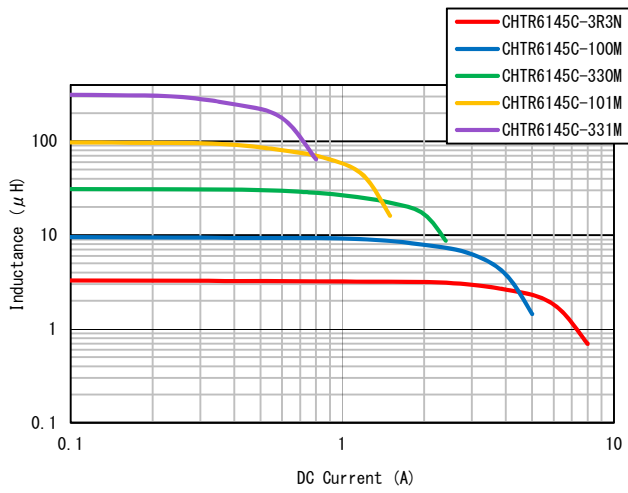

## ■ Characteristics of Temperature rise

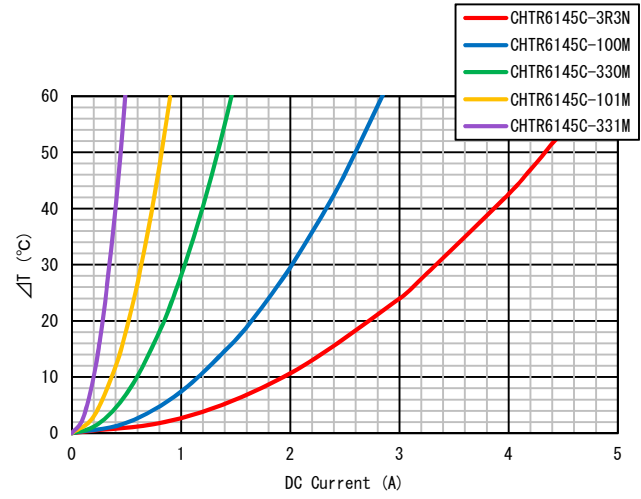

SAGAMI ELEC CO., LTD.  
<https://www.sagami-elec.co.jp>

10-30, Ichibashimo-cho, Tsurumi-ku, Yokohama, Kanagawa 230-0024, Japan  
 Over Seas Sales Dept. TEL: +81 45 511 3141, E-mail: ossg@sagami-elec.co.jp  
 Engineering Dept. TEL: +81 45 521 4543

⚠ The contents of this catalogue are subject to change without notice.