

Fixed Inductor for Digital Amp. (Class-D)

HER7052C

■ Features

- Small size Inductor For LPF of Digital Amplifier (Class-D)
- Improved the current characteristic by changing the material of core.
- Operating Temperature Range: $-40 \sim +125^{\circ}\text{C}$ (include self-heating)
- **AEC-Q200 compliance**
- RoHS compliance



Weight: 0.82g

■ Application

- For LCD TV, desk top audio, car audio, amusement, and so on

■ Dimensions

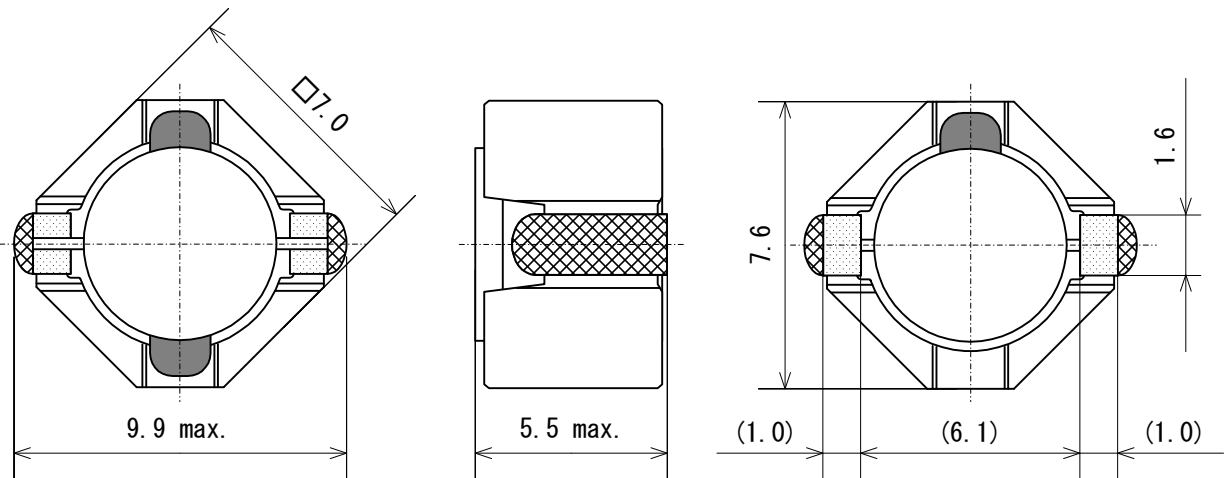

(Unit : mm)

■ Recommended Land Pattern

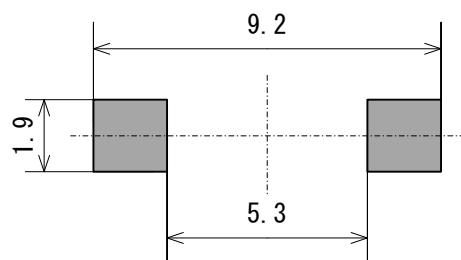

(Unit : mm)



SAGAMI ELEC CO., LTD.
<http://www.sagami-elec.co.jp>

10-30, Ichibashimo-cho, Tsurumi-ku, Yokohama, Kanagawa 230-0024, Japan
 Over Seas Sales Dept. TEL : +81 45 511 3141, E-mail : ossg@sagami-elec.co.jp
 Engineering Dept. TEL : +81 45 521 4543, E-mail : tech@sagami-elec.co.jp

New Products

Fixed Inductor for Digital Amp. (Class-D)

HER7052C vs DER7052

■ Characteristics of DC Saturation Current

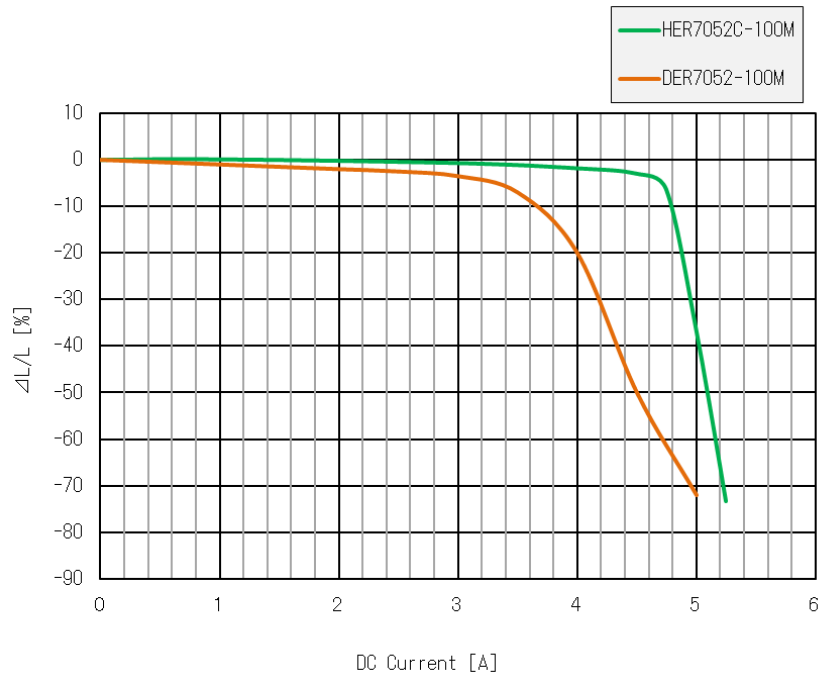

■ Characteristics of Temperature rise

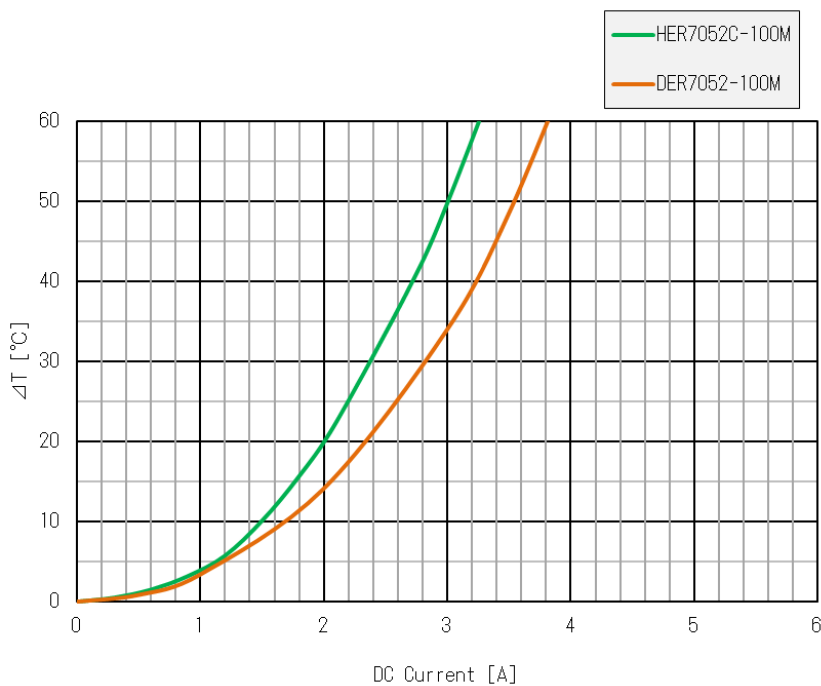

SAGAMI ELEC CO., LTD.
<http://www.sagami-elec.co.jp>

10-30, Ichibashimo-cho, Tsurumi-ku, Yokohama, Kanagawa 230-0024, Japan
Over Seas Sales Dept. TEL : +81 45 511 3141, E-mail : ossg@sagami-elec.co.jp
Engineering Dept. TEL : +81 45 521 4543, E-mail : tech@sagami-elec.co.jp

Fixed Inductor for Digital Amp. (Class-D)

HER7052C Current Characteristic

■ Characteristics of DC Saturation Current

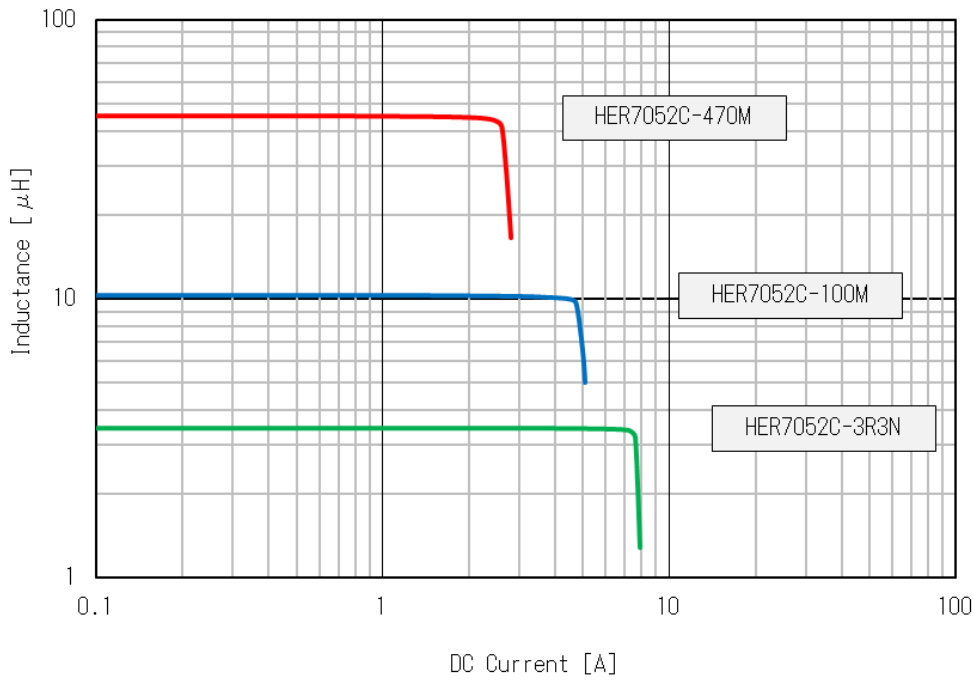

■ Characteristics of Temperature rise

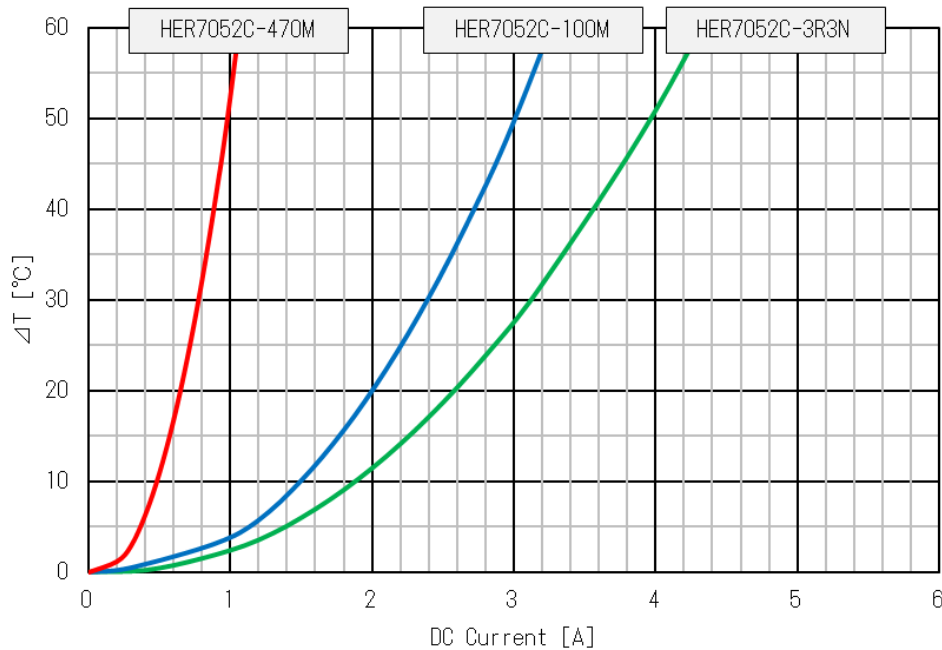

SAGAMI ELEC CO., LTD.
<http://www.sagami-elec.co.jp>

10-30, Ichibashimo-cho, Tsurumi-ku, Yokohama, Kanagawa 230-0024, Japan
 Over Seas Sales Dept. TEL : +81 45 511 3141, E-mail : ossg@sagami-elec.co.jp
 Engineering Dept. TEL : +81 45 521 4543, E-mail : tech@sagami-elec.co.jp

Fixed Inductor for Digital Amp. (Class-D)

■ Electrical Specification

P/N	Inductance (μ H)	DC Resistance (Ω)	DC Superposition Allowable Current (A)	Temperature Rise Allowable Current (A)
HER7052C-3R3N	3.3 \pm 30%	0.031 \pm 30%	6.7	2.6
HER7052C-4R7N	4.7 \pm 30%	0.037 \pm 30%	6.2	2.4
HER7052C-8R2N	8.2 \pm 30%	0.049 \pm 30%	4.2	2.1
HER7052C-100M	10 \pm 20%	0.056 \pm 30%	3.8	2.0
HER7052C-150M	15 \pm 20%	0.085 \pm 30%	3.3	1.5
HER7052C-220M	22 \pm 20%	0.14 \pm 30%	2.8	1.2
HER7052C-330M	33 \pm 20%	0.26 \pm 30%	2.3	0.84
HER7052C-470M	47 \pm 20%	0.38 \pm 30%	1.9	0.65

* Inductance Measuring Condition : 100kHz, 1V

* Rated current : DC saturation allowable current or Temperature rise allowable current, whichever is smaller.

1. DC Saturation Allowable Current : value of inductance decrease within 30%.
2. Temperature Rise Allowable Current : A rise in temperature of core surface is within 40°C.



SAGAMI ELEC CO., LTD.
<http://www.sagami-elec.co.jp>

10-30, Ichibashimo-cho, Tsurumi-ku, Yokohama, Kanagawa 230-0024, Japan
 Over Seas Sales Dept. TEL : +81 45 511 3141, E-mail : ossg@sagami-elec.co.jp
 Engineering Dept. TEL : +81 45 521 4543, E-mail : tech@sagami-elec.co.jp